

NovaFlex[®] Hi-Flow[™] Dry-Release[™] Couplings 'HDC'

HDC-CPL 1½" - 2" Stainless Steel 316L

Dry-Release Coupler
 PART ID: 8CPLSV01.5
 PART ID: 8CPLSV02

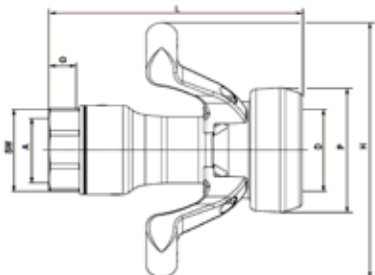

Material: Stainless Steel 316L

NPS Size	D Socket	A Connection	G Thread Length	L Length	P Protection Ring	H (with Handles)	Weight kg/lbs	Pressure
1½"	70 mm	NPT ANSI B2.1	18.4mm/0.72"	168 mm/6.61"	98 mm	200mm	2.4 Kg/5.31lbs	25bar/362psi
2"	70 mm	BSP ISO 228-G 2	20.0 mm/0.78"	164 mm/6.45"	98 mm	200mm	2.4 Kg/5.31lbs	25bar/362psi
2"	70 mm	NPT ANSI B2.1	21.5 mm/0.84"	168 mm/6.61"	98 mm	200mm	2.4 Kg/5.31lbs	25bar/362psi

HDC-ADP 1½" - 2" Stainless Steel 316L

Dry-Release Adapter
 PART ID: 8ADPSV01.5
 PART ID: 8ADPSV02

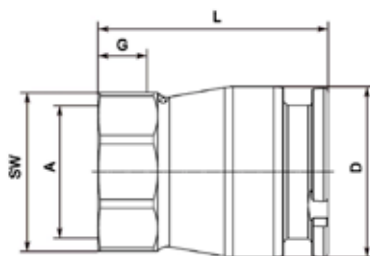

Material: Stainless Steel 316L

NPS Size	D Socket	A Connection	G Thread Length	L Length	Weight kg/lbs	Pressure
1½"	70 mm	NPT ANSI B2.1	18.4mm/0.72"	94.0 mm/3.7"	0.87 Kg/1.91lbs	25bar/362psi
2"	70 mm	BSP ISO 228-G 2	20.0 mm/0.78"	92.5 mm/3.64"	0.86 Kg/1.89lbs	25bar/362psi
2"	70 mm	NPT ANSI B2.1	21.5 mm/0.84"	94.0 mm/3.7"	0.87 Kg/1.91lbs	25bar/362psi