

HDC-CPL 1½" - 2" Aluminum

Dry-Release Coupler
PART ID: 8CPLAV01.5
PART ID: 8CPLAV02

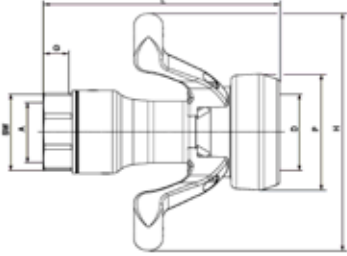

Material: Aluminum

NPS Size	D Socket	A Connection	G Thread Length	L Length	P Protection Ring	H (with Handles)	Weight kg/lbs	Pressure*
1½"	70 mm	NPT ANSI B2.1	18.4mm/0.72"	168 mm/6.61"	98 mm	200mm	1.2 Kg/2.64lbs	16-25bar/232-362psi
2"	70 mm	BSP ISO 228-G 2	20 mm/0.78"	164 mm/6.45"	98 mm	200mm	1.2 Kg/2.64lbs	16-25bar/232-362psi
2"	70 mm	NPT ANSI B2.1	21.5 mm/0.84"	168 mm/6.61"	98 mm	200mm	1.2 Kg/2.64lbs	16-25bar/232-362psi

HDC-ADP 1½" - 2" Aluminum

Dry-Release Adapter
PART ID: 8ADPAV01.5
PART ID: 8ADPAV02

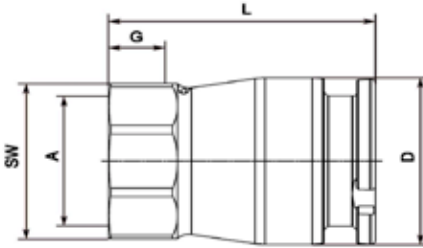

Material: Aluminum

NPS Size	D Socket	A Connection	G Thread Length	L Length	Weight kg/lbs	Pressure*
1½"	70 mm	NPT ANSI B2.1	18.4mm/0.72"	94 mm/3.7"	0.46 Kg/1.01lbs	16-25bar/232-362psi
2"	70 mm	BSP ISO 228-G 2	20.0 mm/0.78"	92.5 mm/3.64"	0.45 Kg/0.99lbs	16-25bar/232-362psi
2"	70 mm	NPT ANSI B2.1	21.5 mm/0.84"	94 mm/3.7"	0.46 Kg/1.01lbs	16-25bar/232-362psi

*High pressure model 25bar/362psi WP available